



THE CITY OF WINNIPEG

PUBLIC WORKS DEPARTMENT

ENGINEERING DIVISION

2019 LOCAL STREET RENEWAL PROGRAM

INGLEWOOD STREET, KIRKFIELD AVENUE AND VARIOUS OTHER LOCATIONS

PAVEMENT REHABILITATION AND RECONSTRUCTION

BID OPPORTUNITY 1271-2019 - CONTRACT No. 3

DRAWING NO.	DESCRIPTION
1271-2019_DRAWING_18M-01969-00-28-RC	INGLEWOOD STREET - NESS AVENUE TO SILVER AVENUE PAVEMENT REHABILITATION STA. 1+00 TO STA. 2+35
1271-2019_DRAWING_18M-01969-00-29-RC	INGLEWOOD STREET - NESS AVENUE TO SILVER AVENUE PAVEMENT REHABILITATION STA. 2+35 TO STA. 3+60
1271-2019_DRAWING_18M-01969-00-30-RC	INGLEWOOD STREET - NESS AVENUE TO SILVER AVENUE PAVEMENT REHABILITATION STA. 3+60 TO STA. 5+11.80
1271-2019_DRAWING_18M-01969-00-31-RC	KIRKFIELD STREET - MCBEY AVENUE TO PORTAGE AVENUE ASPHALT RECONSTRUCTION STA. 1+00 TO STA. 2+40
1271-2019_DRAWING_18M-01969-00-32-RC	KIRKFIELD STREET - MCBEY AVENUE TO PORTAGE AVENUE ASPHALT RECONSTRUCTION STA. 2+40 TO STA. 3+85.46
1271-2019_DRAWING_18M-01969-00-33-RC	LILAC STREET - FLEET AVENUE TO MULVEY AVENUE PAVEMENT REHABILITATION STA. 1+00 TO STA. 1+88.62
1271-2019_DRAWING_18M-01969-00-34-RC	OLIVE STREET - NESS AVENUE TO BRAINTREE CRESCENT ASPHALT RECONSTRUCTION STA. 1+00 TO STA. 1+69.73
1271-2019_DRAWING_18M-01969-00-35-RC	PALLISER AVENUE - MT ROYAL ROAD TO MT ROYAL ROAD PAVEMENT REHABILITATION STA. 1+00 TO STA. 2+50
1271-2019_DRAWING_18M-01969-00-36-RC	PALLISER AVENUE - MT ROYAL ROAD TO MT ROYAL ROAD PAVEMENT REHABILITATION STA. 2+50 TO STA. 3+70
1271-2019_DRAWING_18M-01969-00-37-RC	PALLISER AVENUE - MT ROYAL ROAD TO MT ROYAL ROAD PAVEMENT REHABILITATION STA. 3+70 TO STA. 4+70
1271-2019_DRAWING_18M-01969-00-38-RC	PALLISER AVENUE - MT ROYAL ROAD TO MT ROYAL ROAD PAVEMENT REHABILITATION STA. 4+70 TO STA. 6+22.22
1271-2019_DRAWING_18M-01969-00-39-RC	WELLINGTON AVENUE - BANNING STREET TO ARLINGTON STREET CONCRETE RECONSTRUCTION STA. 0+71.42 TO STA. 2+05
1271-2019_DRAWING_18M-01969-00-40-RC	WELLINGTON AVENUE - BANNING STREET TO ARLINGTON STREET CONCRETE RECONSTRUCTION STA. 2+05 TO STA. 3+16.36

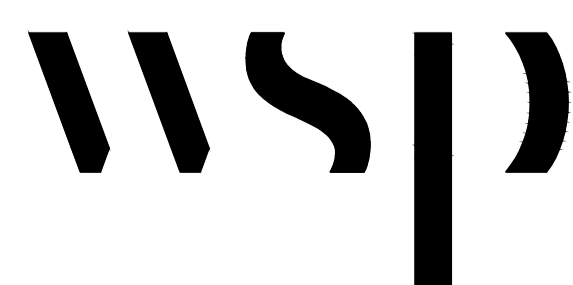
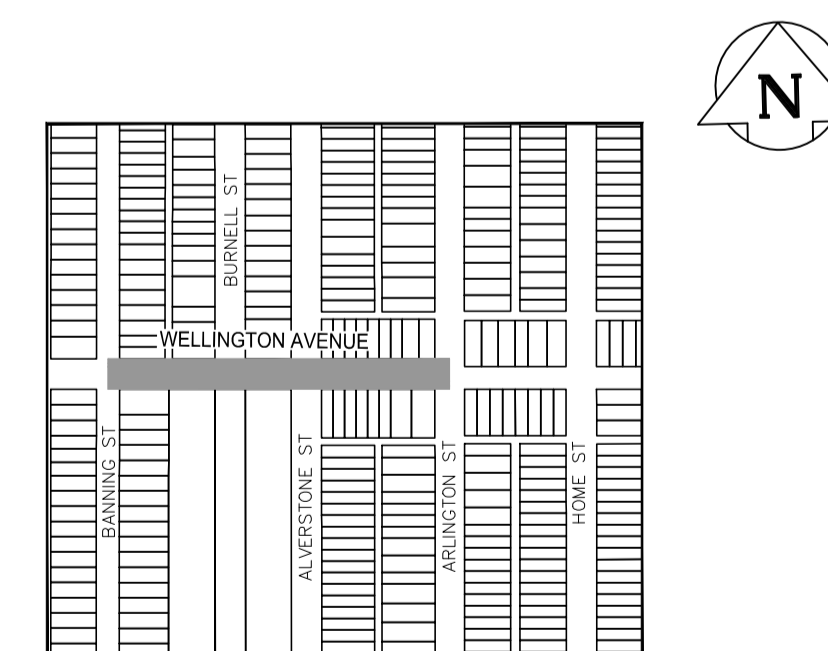
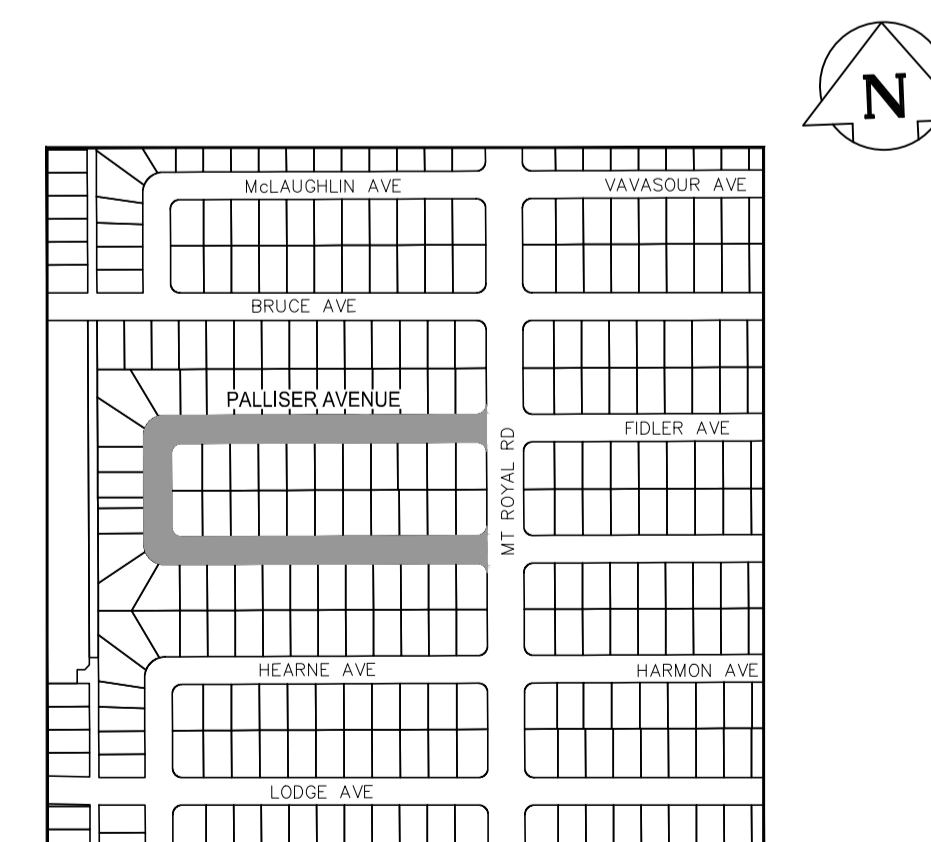
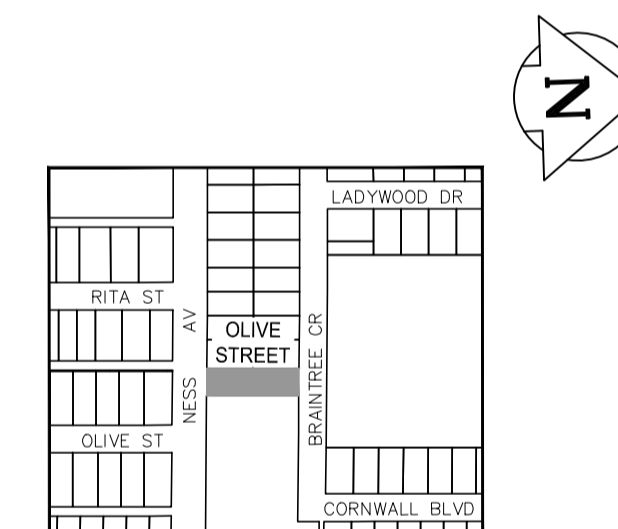
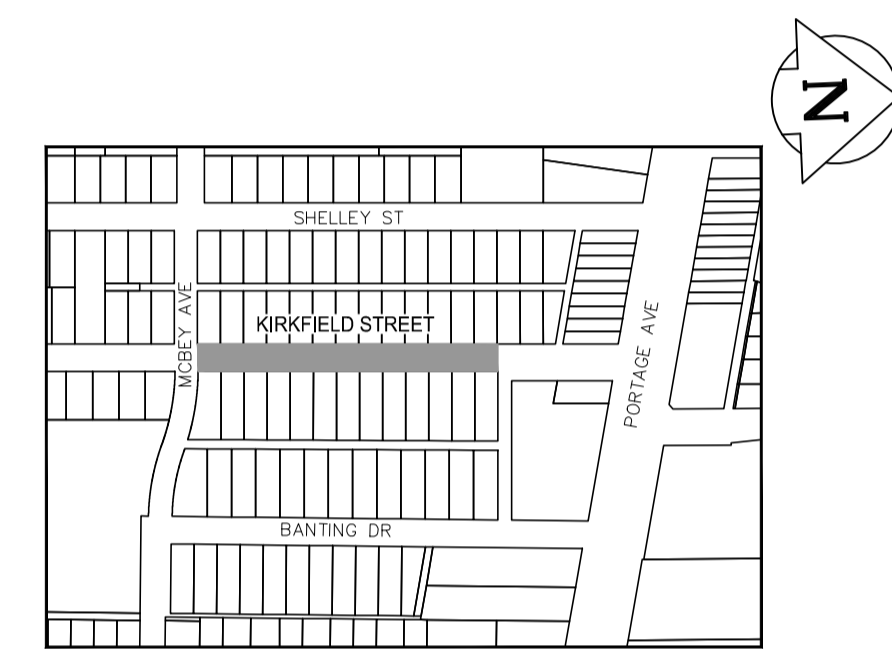
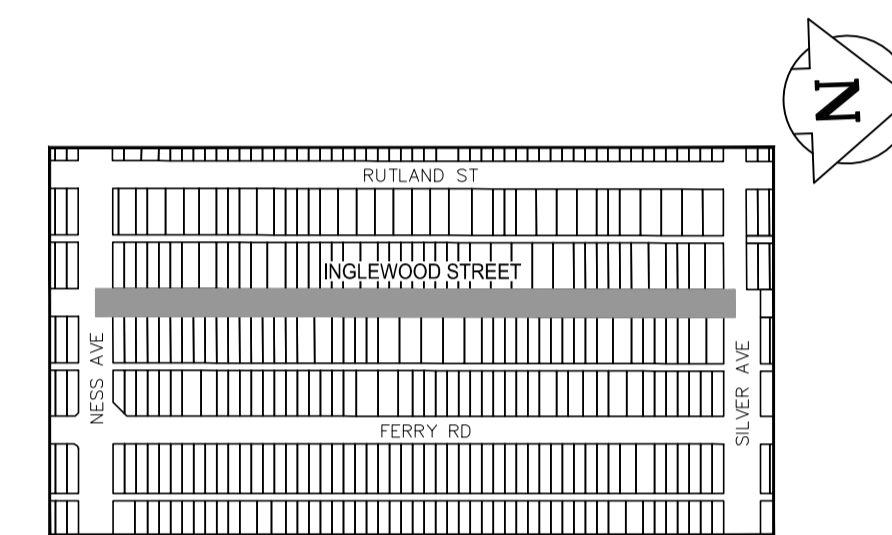

WSP Canada Group Limited
 Suite 111 - 93 Lombard Ave
 Winnipeg, MB R3B 3B1
 t. 204.943.3178
 f. 204.943.4948
 www.wsp.com



ISSUED FOR CONSTRUCTION

RELEASE FOR CONSTRUCTION BY:

XXXXXXXX

XXXXXX

P:\2018\18M-01969-00 - 2019 Local Streets Package_18-R-03\Contract_3\10 Drawings\03 Working Drawings\18M-01969-Cover Page Contract No. 3.dwg - 1271-2019_Drawing_Cover Page_RC